

# Core & Coil (71A) LPS

## CORE & COIL HID LPS BAL 18W L69 120/277V C&C

The basic ballast is the open core and coil which is most often used as a component within a lighting luminaire. The core and coil also forms the nucleus of Philips Advance's five other ballast configurations.

### Product data

General Information			
ANSI Code	L69	Secondary Short Circuit Current	0.3-0.4 A
Lamp Type	18W LPS	Constant Wattage Deviation	10%
Number of Lamps	1 piece/unit	Ballast Factor (Nom)	1
Circuit Type	HX-HPF	Power Factor (Nom)	0.90
Ballast Type	Magnetic HID	Nominal Open Circuit Voltage	315 V
Base Model	71A0280	Input Current (Operating) (Nom)	0.27/0.12 A A
Core Size	3 X 4 (2 coil)	Input Power (Nom)	30 W
Suitable For Outdoor Use	Yes	Rated Lamp Watts	18W W
Capacitor Value	5 MFD		
Capacitor Catalog Number	7C050L30RA		
Capacitor Requirements	250V		
Capacitor Temperature Rating	105°C		
Capacitor Diameter/Oval Dimensions	1.25 in		
Capacitor Height	2.25 in		
Automatic Restart	No		
Operating and Electrical		Wiring	
Input Voltage	120/277 V	Wire Striplength	0.5 mm
Input Frequency	60 Hz	Wire Length By Color	12"
Inp. Current (Open Circuit)	0.85/0.40 A	Wire Type	Stranded
Input Current (Starting)	0.30/0.13 A	Remote Wiring Configuration Allowed	Yes
Input Current (Short Circuit)	0.1-0.2/0.05-0.1 A	Max Ballast-Lamp Distance Remote Wiring	Determined by AWG used
		Recommended Fuse Value	3/2 A
		Approval and Application	
		Open Circuit Voltage Test (Volts)	280-350 V
		Approbation Marks	ULR CSA certificate RoHS Compliant
		Temperature Marking	A/A
		UL Recognized	Yes
		Hipot Test (1 Minute)	2000 V

Core & Coil (71A) LPS

Hipot Test (2 Seconds)	2500 V
UL Insulation Class	H(180°C)
UL Temperature Code	1029A
Product Data	
Order product name	CORE & COIL HID 71A0280500D
EAN/UPC - Product	781087028056

Order code	71A0280500D
Numerator - Quantity Per Pack	1
Numerator - Packs per outer box	9
Material Nr. (12NC)	913700527309
Net Weight (Piece)	1.629 kg

Dimensional drawing

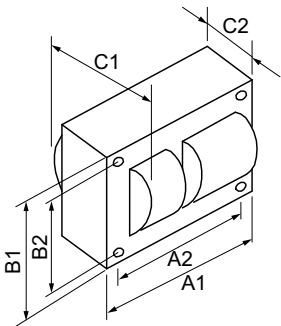

Product	C1	C2	A1	A2	B1	B2
CORE & COIL HID 71A0280500D	2.4 in	1 in	3.9 in	3.5 in	2.8 in	2.4 in

LPS BAL 18W L69 120/277V C&C

